

MEMORABLE MEETINGS. DISTINCTLY DALLAS.

SOPHISTICATED MEETINGS

The Highland Dallas - A Curio Collection by Hilton is a unique luxury boutique experience at the crossroads of style and comfort, culture and creativity, historic ties and modern touches all in the heart of Dallas.

HOTEL ROOMS

The hotel offers 198 guest rooms, including 9 suites, 52 double-double rooms. All guestrooms and suites feature:

- Selected views overlooking the SMU Campus, George Bush Presidential Library and our relaxing pool area
- Plush high thread-count, all-cotton linens and padded headboards
- Gilchrist & Some's Bath Products
- Comfortable desks and ergonomic chairs
- 24-Hour Room Service
- Plush Highland Dallas signature robes
- Turn-down upon request
- Pet-friendly amenities

KNIFE

Open daily for breakfast, lunch and dinner, KNIFE Restaurant & Bar showcases the award-winning cuisine of James Beard-nominated and "Top Chef" contestant, Chef John Tesar. Dedicated to using the finest quality, locally-sourced ingredients, Chef Tesar has created a menu of signature dishes for guests to enjoy.

PRIVATE DINING

THE PRIVATE DINING ROOM

Semi-private dining can accommodate up to 30 seated guests and features a lounge with gas fireplace.

TERRACE AT KNIFE

Flagstone paving, contemporary style, fireplace and garden views can accommodate up to 125 guests reception style

KNIFE DINING ROOM

Dining room can accommodate up to 85 seated guests.

HOTEL AMENITIES

The Highland Dallas has a 24-hour state-of-the-art fitness center and a heated infinity pool.

Our **Exhale Spa** has a full menu of spa services, signature core fusion and yoga classes, and a Mind Body gym.

Salon Pompeo, our on-site, full-service salon for men and women, includes manicures, pedicures, tanning, and bridal packages for your special day.

MEETING SPACE

The Highland Dallas offers more than 13,000 sq. ft of meeting space. Event space can accommodate 100-500 banquet attendees and the hotel can accommodate from 10-150 guest rooms for attendees per night.



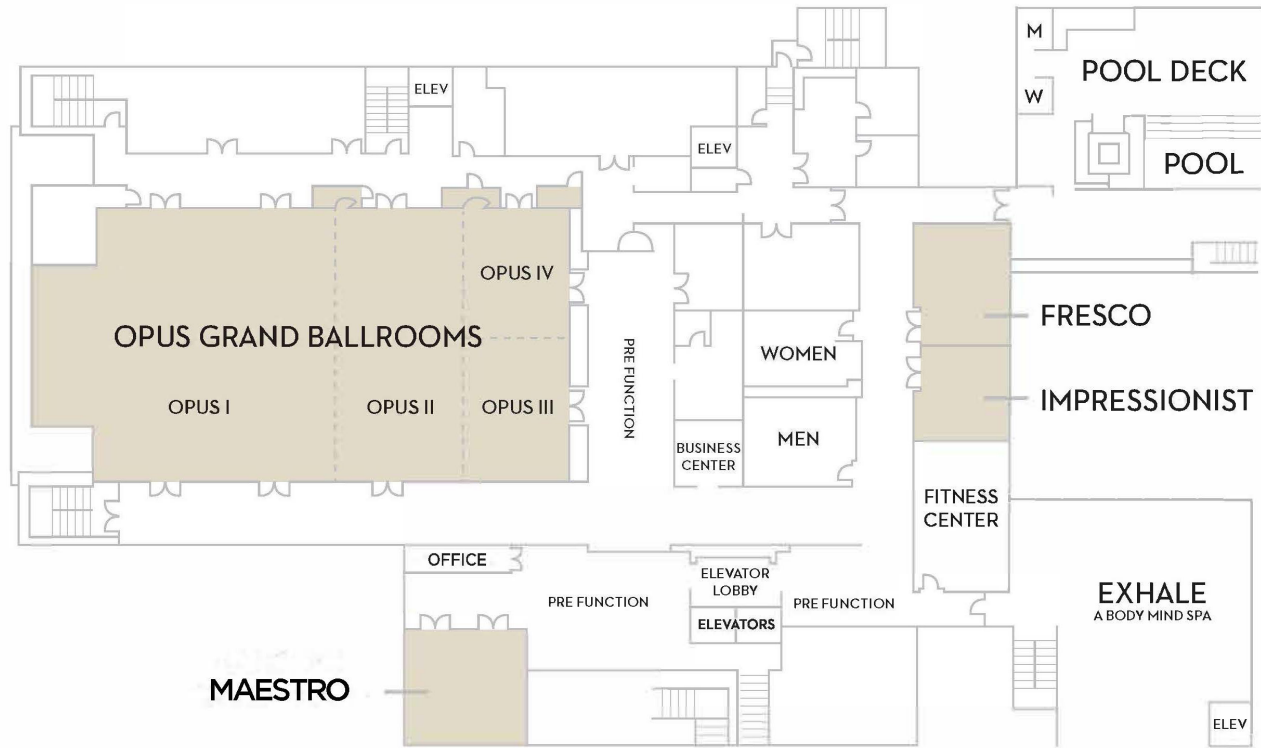

ROOM	SQ FT	DIMENSIONS	CLASSROOM 2/6	CLASSROOM 3/6	CONFERENCE	THEATRE	BANQUET RNDs OF 10	RECEPTION	HOLLOW SQUARE	U-SHAPE	8x10 BOOTHS
OPUS BALLROOM	6588	108' X 61' X 14'	274	315	-	500	400	500	126	150	41
OPUS 1	3416	56' X 61' X 14'	128	192	40	300	200	400	84	63	21
OPUS 2	1830	30' X 61' X 14'	60	90	48	100	100	200	60	57	11
OPUS 3	750	30' X 25' X 14'	20	36	22	50	30	50	24	28	5
OPUS 4	750	30' X 25' X 14'	20	36	22	50	30	50	24	28	5
OPUS 1 & 2	5246	86' X 61' X 14'	188	282	-	400	300	500	108	84	33
OPUS 3 & 4	1500	60' X 25' X 14'	52	78	44	160	80	100	36	43	9
OPUS 2, 3 & 4	3330	55' X 61' X 14'	112	168	40	-	150	150	80	95	21
MAESTRO	806	31' X 26' 10"	24	30	20	60	40	50	20	20	-
FRESCO	550	22' X 25' 10"	16	24	22	56	40	50	24	20	3
IMPRESSIONIST	480	20' X 24' X 10"	8	12	12	36	30	30	15	10	3
KNIFE PRIVATE DINING ROOM	425	25' X 17'	-	-	-	-	30	50	-	-	-
KNIFE PRIVATE TER- RACE	1650	50' X 33'	-	-	-	-	80	150	-	-	-
POOL DECK	2,752	86' X 32'	-	-	-	-	-	100	-	-	-
PARLOR SUITE	516	21'7" X 24'	-	-	-	-	40	50	-	-	-
MAESTRO PRE-FUNC- TION	875	35' X 25'	-	-	-	-	50	100	-	-	5
OPUS PRE-FUNCTION	1180	59' X 20'	-	-	-	-	90	200	-	-	7
EXHALE PRE FUNCTION	442	15'5" X 28'7"	-	-	-	-	30	55	-	-	2

TO BOOK YOUR EVENT, CALL 214.560.2732
OR EMAIL SALES@THEHIGHLANDDALLAS.COM